

# T PNEUMATIC VIBRATORS

1.PICTURE:

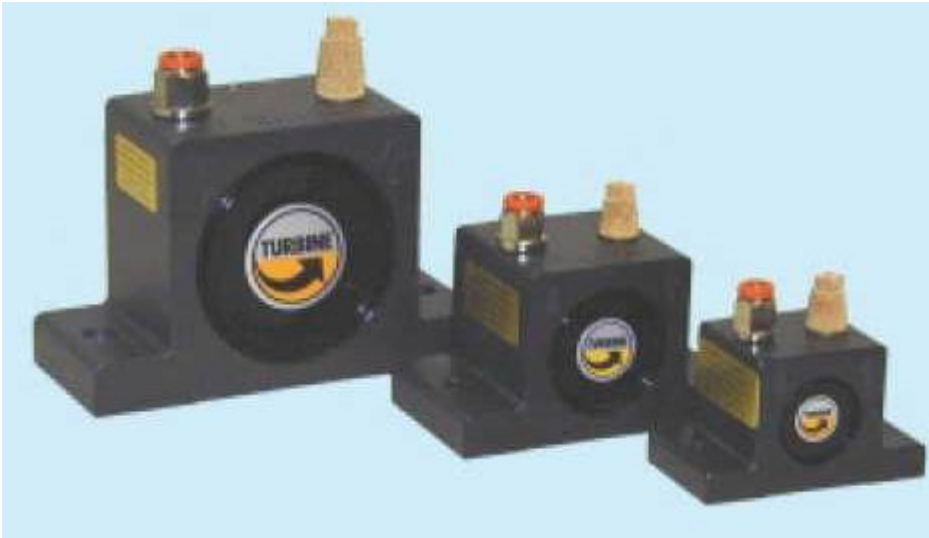

2.CHARACTERISTIC:

- Lower speed range
- Large working moment
- Require air line filter and lubricator

3.DIMENSIONS:

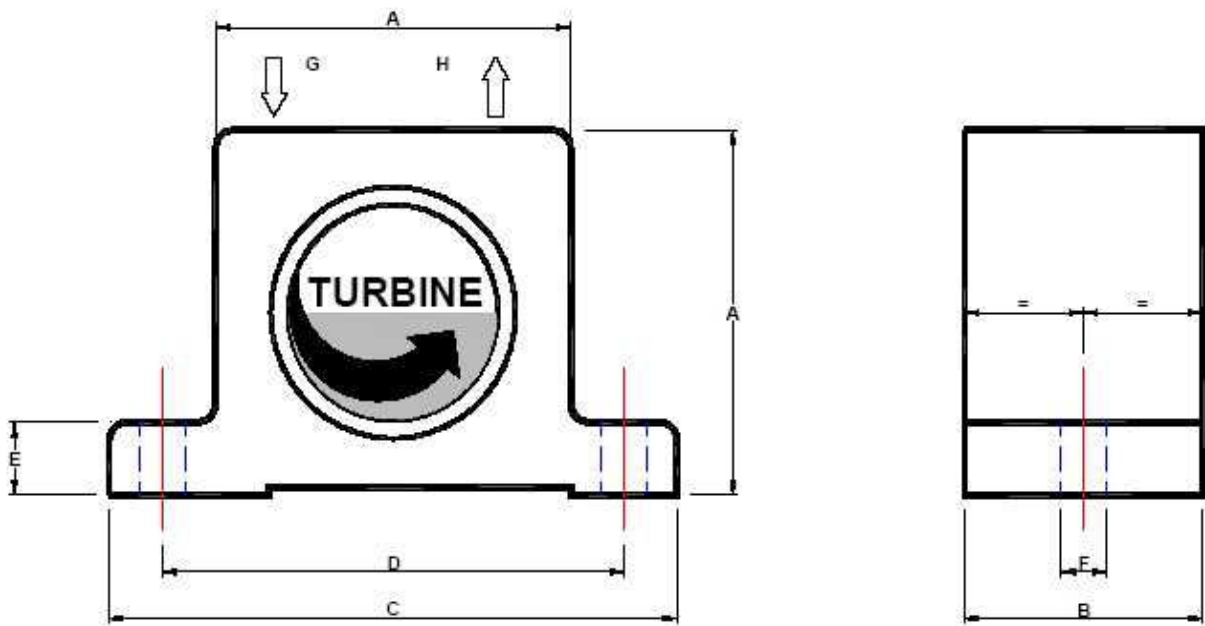

\*\*\*DETAILED DATA IN NEXT PAGE\*\*\*

# T PENUMATIC VIBRATORS

型号	A		B		C		D		E		F		G*	H*	重量	
	mm	inch	mm	inch	mm	inch	mm	inch	mm	inch	mm	inch	BSP	BSP	kg	Lbs
T50/LP	50	1.97	46	1.81	86	3.38	68	2.68	12	0.47	7	0.27	1/8"	1/4"	0.385	0.86
T50/HP	50	1.97	60	2.36	86	3.38	68	2.68	12	0.47	7	0.27	1/8"	1/4"	0.52	1.15
T65/LP	65	2.56	50	1.97	113	4.45	90	3.54	16	0.63	9	0.35	1/4"	1/4"	0.735	1.6
T65/HP	65	2.56	64	2.52	113	4.45	90	3.54	16	0.63	9	0.35	1/4"	1/4"	0.975	2.15
T80/LP	80	3.15	56	2.2	128	5.04	104	4.09	16	0.63	11	0.43	1/4"	3/8"	1.21	2.7
T80/HP	80	3.15	70	2.75	128	5.04	104	4.09	16	0.63	11	0.43	1/4"	3/8"	1.56	3.45
T100/HP	100	3.94	67	2.64	160	6.3	130	5.12	20	0.79	13	0.51	3/8"	3/8"	2.27	5

## 5.FEATURE:

型号	频率 V. P. M			测得的离心力						空气消耗/分钟						噪音等级 dBA
	2Bar	4Bar	6Bar	2Bar=29P		4Bar=58PS		6Bar=87PS		2Bar=29P		4Bar=58PS		6Bar=87PS		
	29PSI	58PSI	87PSI	N	LBS	N	LBS	N	LBS	Ltr	CF	Ltr	CF	Ltr	CF	
T50/LP	13500	17500	15500	390	88	660	149	820	185	67	2.4	115	4	165	5.8	69-80
T50/HP	9500	13000	13800	470	106	860	194	1220	275	79	2.8	140	4.9	198	7	67-79
T65/LP	9300	12000	9000	700	158	1170	263	1550	349	89	3.1	157	5.5	236	8.3	74-80
T65/HP	5200	7500	9700	510	115	1060	239	1530	344	108	3.8	193	6.8	290	10.2	69-79
T80/LP	5000	8000	7500	550	124	1400	315	2050	461	150	5.3	260	9.2	385	13.6	67-76
T80/HP	N/A	5600	6800	N/A	N/A	1350	304	2420	545	NA	NA	260	9.2	385	13.6	67-76
T100/HP	N/A	5900	390	N/A	N/A	2020	455	2690	605	NA	NA	300	10.6	430	15.2	70-78