

# Afc3000 series vibrators

Afc3000 series vibrators are suitable for formwork or vibrating tables to realize concrete manufactures ,with high frequency vibrations optimized by a precise speed regulation.This allows an optimum rendering of the plant and a remarkable lowering of the noise in relation to traditional systems.

## 1.PICTURE:



## 2.CHARACTERISTIC:

Standard voltage input;  
 42V low voltage input;  
 Standard 2 poles;  
 Can be driven by any kind of PWN with torque inverter;  
 (the rapid coupling is supplied separately)

## 3.DIMENSIONS:

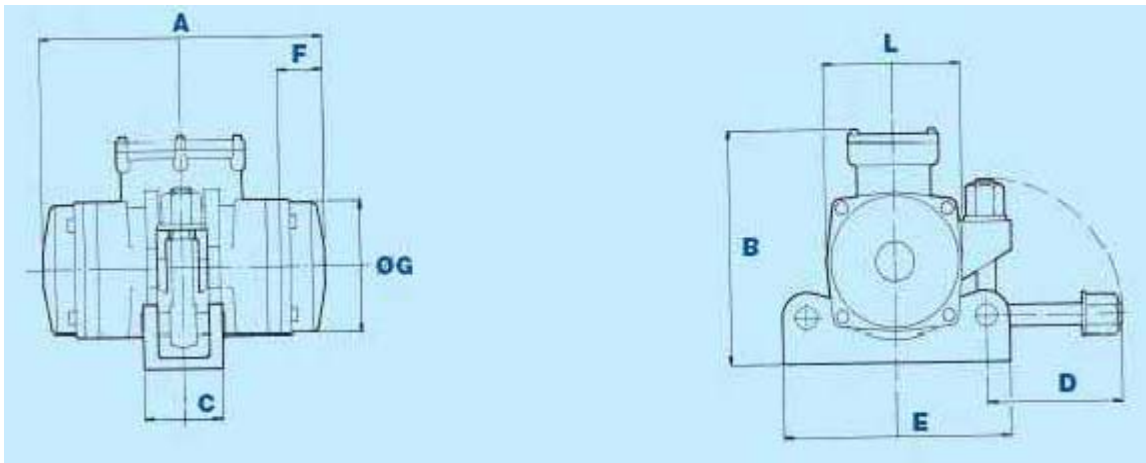

CODICE CODE CODE KODE	TIPO TYPE TYPE TYP	GRAND. SIZE GRAND. GRÖSSE	DIMENSIONI D'INGOMBRO OVERALL DIMENSIONS COTES DIMENSIONS ABMESSUNGEN (mm)										ATTACCO TIPO COUPLING TYPE ATTACHE TYPE HALTERUNG TYP
			A	B	C	D	E	F	Ø G	L	Ø PG		
			AC30-0080	AFC 800/3	AF10C	356	218	84	145	240	82	122	
AC30-0150	AFC 1500/3	AF15C	402	225	84	145	240	106	134	140	16	2	

# Afc3000 series vibrators

## 4.ELECTRIC FEATURES:

CODICE CODE CODE KODE	TIPO TYPE TYPE TYP	GRAND. SIZE GRAND. GRÖSSE	CARATTERISTICHE MECCANICHE MECHANICAL FEATURES CARACTERISTIQUES MECANIKUES MECHANISCHE DATEN						CARATTERISTICHE ELETTRICHE ELECTRICAL FEATURES CARACTERISTIQUES ELECTRIQUES ELEKTRISCHE DATEN					
			rpm rpm tr/min min-1		激振力 kg		重量 kg		POTENZA NOMINALE INPUT POWER PUISSANCE NOM. NENNLEISTUNG (W)		CORRENTE NOMINALE NOMINAL CURRENT COURANT NOMINALE NENNSTROM (A)			
			50Hz	60Hz	50Hz	60Hz	50Hz	60Hz	50Hz	60Hz	50Hz		60Hz	
											400V	42V	460V	42V
AC30-0080	AFC 800/3	AF10C			873	850	20,5	20	650	750	1,1	10,5	1,1	12,0
AC30-0150	AFC 1500/3	AF15C	3000	3600	1395	1440	30	28,5	900	1000	1,5	14,3	1,5	16,4